



Product Model Number

CKO-CH15-060027-4303

✓ Model Number Definitions

CKO-XXXX-XXXXXX-XXXX



- A. Chun Kuang Optics Corp. Product
- B. Product Type: product abbreviation
Ex:
CH→CoB High Intensity
CC→CoB Compact
CS→Soft Shading for CoB LED
HC→Holder for CoB LED

- C. Identity Code
- D. Lens / Fixture Size
Ex: 075026=Φ75mm / Thickness=26mm (round up)
- C. Serial Numbers

The lens datasheet is applicable for **Citizen LED**, that manufactured by Chun Kuang Optics Corp.

✓ Dimensions (mm) : Φ60 x 26.85

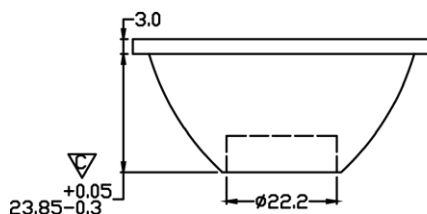
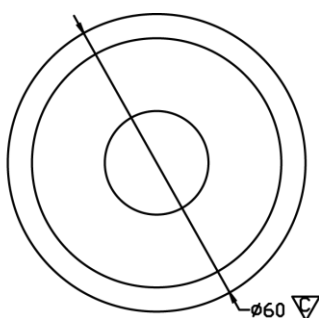

▽:Critical Dimension



Optical Characteristics

Model Number	CKO-CH15-060027-4303	<p>"H" definition</p>
LED	CLU 711	
LES / LED Size	Φ 8.5 mm	
FWHM (D50)	19°	
Field Angle (D10)	41°	
H (distance)	3.65 mm	
Dimension	Φ =60 mm, Thickness=26.85 mm	
Luminous Flux	2900 lm	
Material	PC / UL94V2	

cd/klm

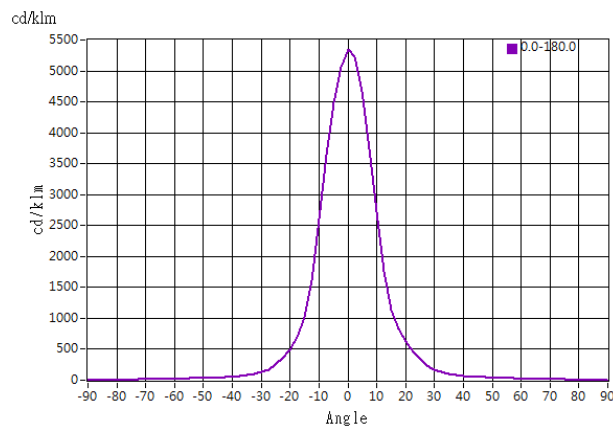

Illuminance At Distances

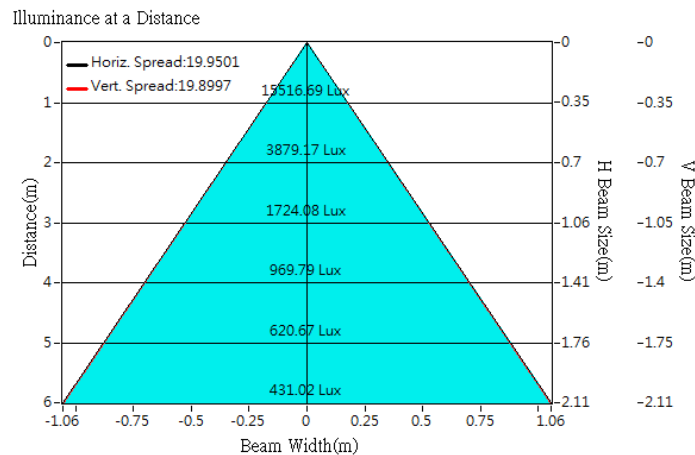



Optical Characteristics

Model Number	CKO-CH15-060027-4303	<p>"H" definition</p>
LED	CLU 710	
LES / LED Size	Φ 8.5 mm	
FWHM (D50)	20°	
Field Angle (D10)	41°	
H (distance)	3.65 mm	
Dimension	Φ =60 mm, Thickness=26.85 mm	
Luminous Flux	2644 lm	
Material	PC / UL94V2	

cd/klm

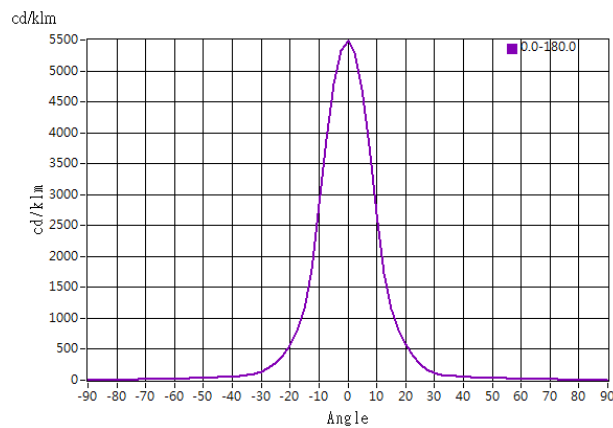

Illuminance At Distances

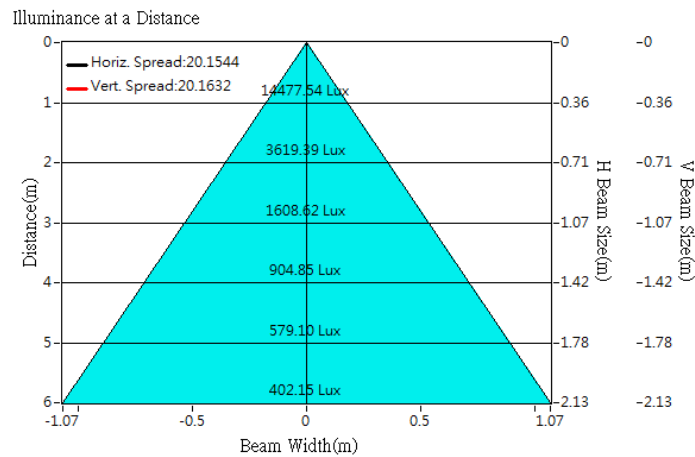



Optical Characteristics

Model Number	CKO-CH15-060027-4303		<p>"H" definition</p>
LED	CLU 028		
LES / LED Size	Φ 9.8 mm		
FWHM (D50)	21°		
Field Angle (D10)	42°		
H (distance)	3.65 mm		
Dimension	Φ =60 mm, Thickness=26.85 mm		
Luminous Flux	1684 lm	Measured @ 12.7 W	
Material	PC / UL94V2		

cd/klm

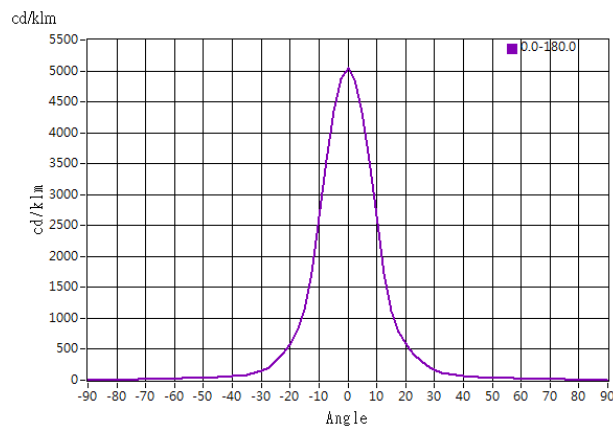

Illuminance At Distances

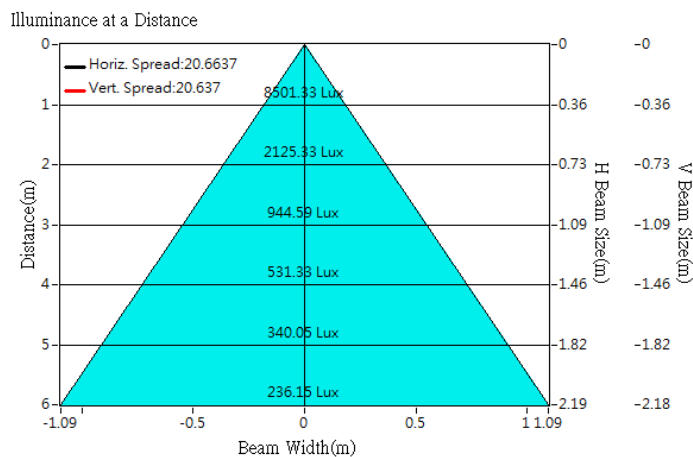



Optical Characteristics

Model Number	CKO-CH15-060027-4303	<p>"H" definition</p>
LED	CLU 026	
LES / LED Size	Φ 9.8 mm	
FWHM (D50)	21°	
Field Angle (D10)	44°	
H (distance)	3.65 mm	
Dimension	Φ =60 mm, Thickness=26.85 mm	
Luminous Flux	1626 lm	
Material	PC / UL94V2	

cd/klm

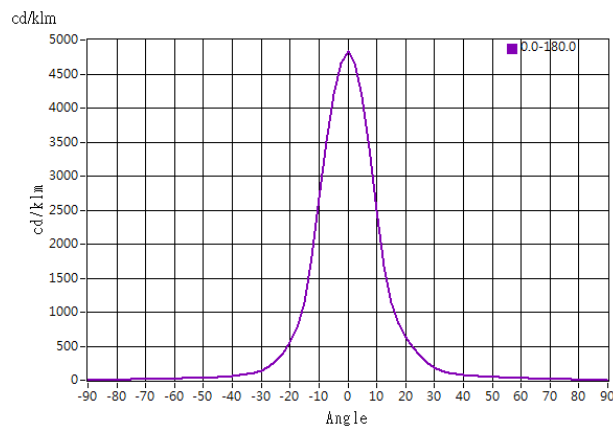

Illuminance At Distances

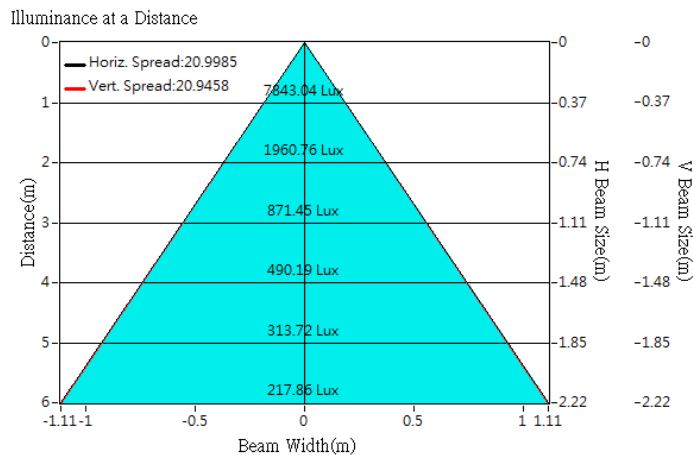

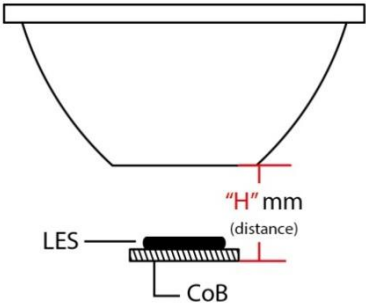

Optical Characteristics

Model Number	CKO-CH15-060027-4303		<p>"H" definition</p> 
LED	CLU 721		
LES / LED Size	Φ 11 mm		
FWHM (D50)	22°		
Field Angle (D10)	45°		
H (distance)	3.65 mm		
Dimension	Φ =60 mm, Thickness=26.85 mm		
Luminous Flux	4217lm	Measured @ 38.8 W	
Material	PC / UL94V2		

cd/klm

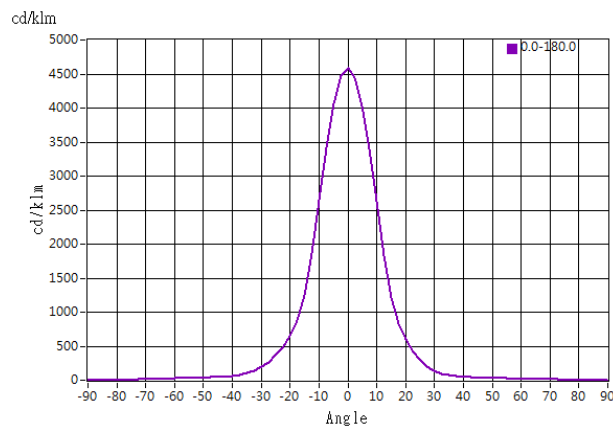

Illuminance At Distances

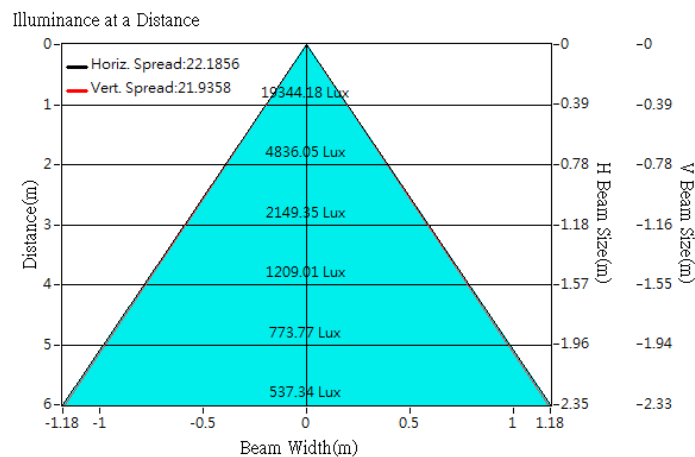



Optical Characteristics

Model Number	CKO-CH15-060027-4303	<p>"H" definition</p>
LED	CLU 720	
LES / LED Size	Φ 11 mm	
FWHM (D50)	21°	
Field Angle (D10)	44°	
H (distance)	3.65 mm	
Dimension	Φ =60 mm, Thickness=26.85 mm	
Luminous Flux	3582 lm	
Material	PC / UL94V2	

cd/klm

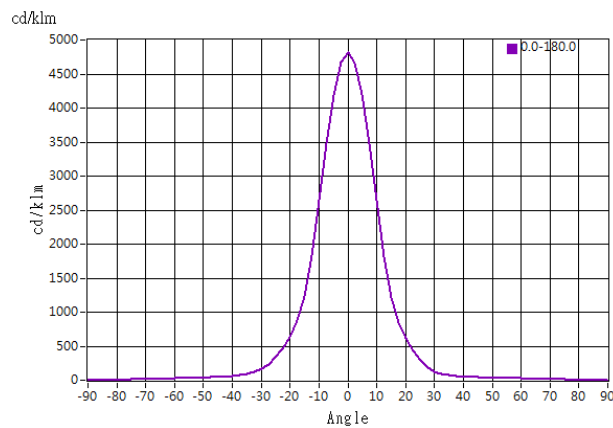

Illuminance At Distances

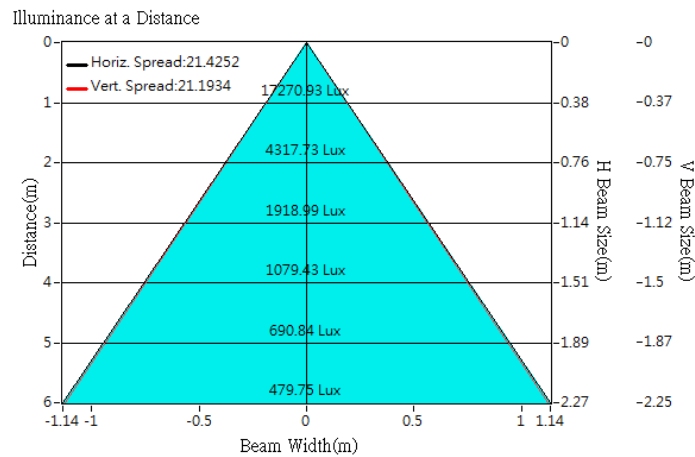



Optical Characteristics

Model Number	CKO-CH15-060027-4303	<p>"H" definition</p>
LED	CLU 038	
LES / LED Size	Φ 14.5 mm	
FWHM (D50)	25°	
Field Angle (D10)	52°	
H (distance)	3.65 mm	
Dimension	Φ =60 mm, Thickness=26.85 mm	
Luminous Flux	2792 lm	
Material	PC / UL94V2	

cd/klm

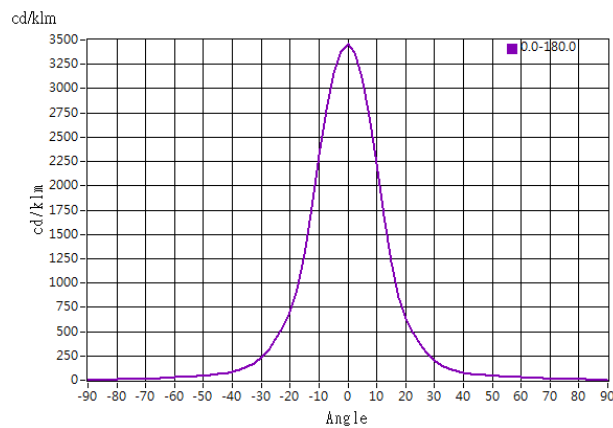

Illuminance At Distances

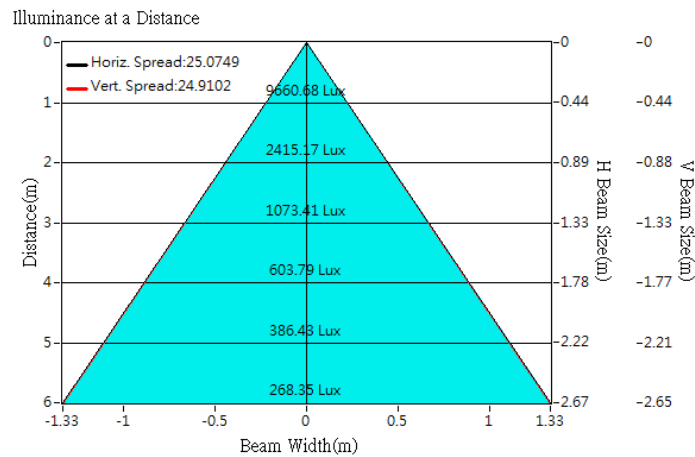



Optical Characteristics

Model Number	CKO-CH15-060027-4303	<p>"H" definition</p>
LED	CLU 034	
LES / LED Size	Φ 14.5 mm	
FWHM (D50)	25°	
Field Angle (D10)	51°	
H (distance)	3.65 mm	
Dimension	Φ =60 mm, Thickness=26.85 mm	
Luminous Flux	2594 lm	
Material	PC / UL94V2	

cd/klm

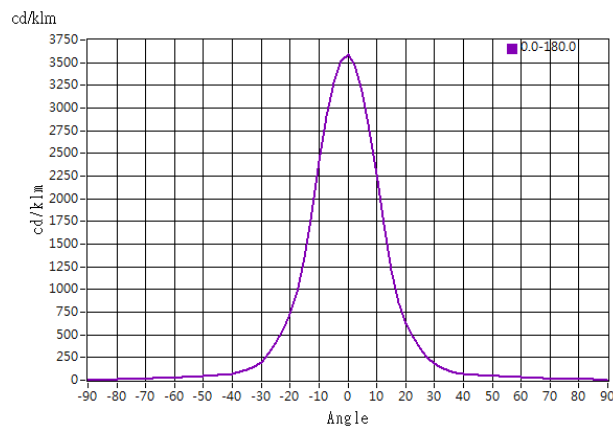

Illuminance At Distances

