



## Product Model Number

CKO-CH15-060027-4307

### ✓ Model Number Definitions

**CKO-XXXX-XXXXXX-XXXX**



- A. Chun Kuang Optics Corp. Product
- B. Product Type: product abbreviation  
Ex:  
CH→CoB High Intensity  
CC→CoB Compact  
CS→Soft Shading for CoB LED  
HC→Holder for CoB LED

- C. Identity Code
- D. Lens / Fixture Size  
Ex: 075026=Φ75mm / Thickness=26mm (round up)
- E. Serial Numbers

The lens datasheet is applicable for **Luminus LED**, that manufactured by Chun Kuang Optics Corp.

### ✓ Dimensions (mm) : Φ60 x 26.85

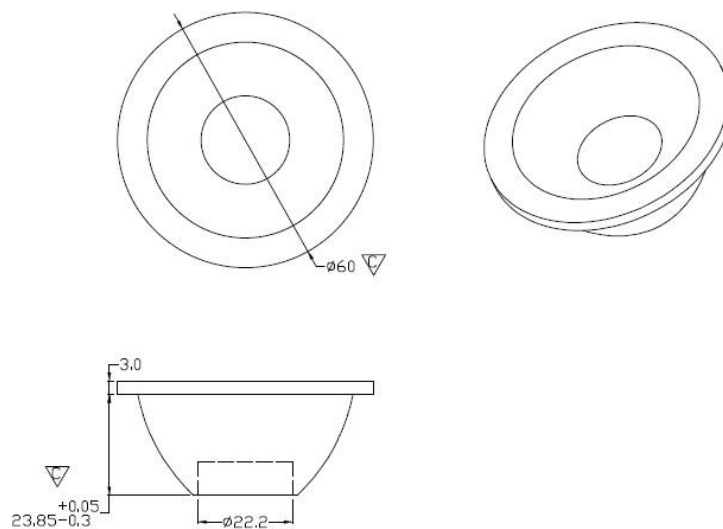

▽:Critical Dimension



✓ Optical Characteristics – Angle Performances

Luminus	LED LES (mm)	FWHM (degrees)	Field Angle (degrees)
CXM-9-AC30	Φ9.6	38°	69°
CXM-9-AC40	Φ9.8	40°	72°
CXM-11-AC30	Φ11.7	41°	73°
CLM-14-AC40	Φ14.5	44°	79°



## Optical Characteristics

Model Number	CKO-CH15-060027-4307		<p>"H" definition</p> <p>LES CoB</p>
LED	<b>CXM-9-AC30</b>		
LES / LED Size	Φ 9.6 mm		
FWHM (D50)	38°		
Field Angle (D10)	69°		
H (distance)	3.65mm		
Dimension	Φ =60 mm, Thickness=26.85 mm		
Luminous Flux	1361 lm	Measured @ 12.1 W	
Material	PC / UL94V2		

## cd/klm

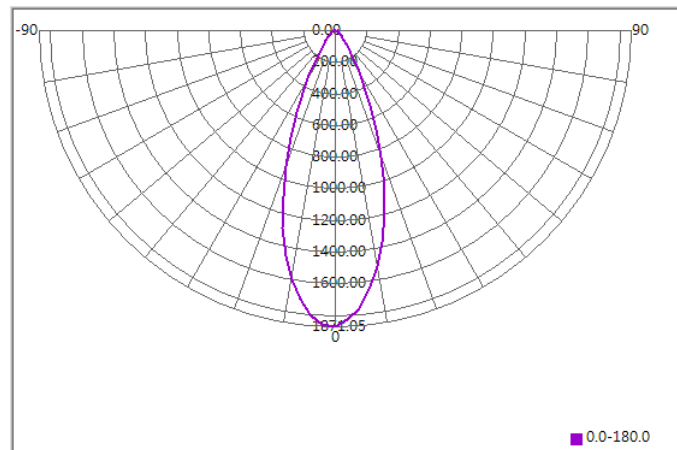

## Illuminance At Distances

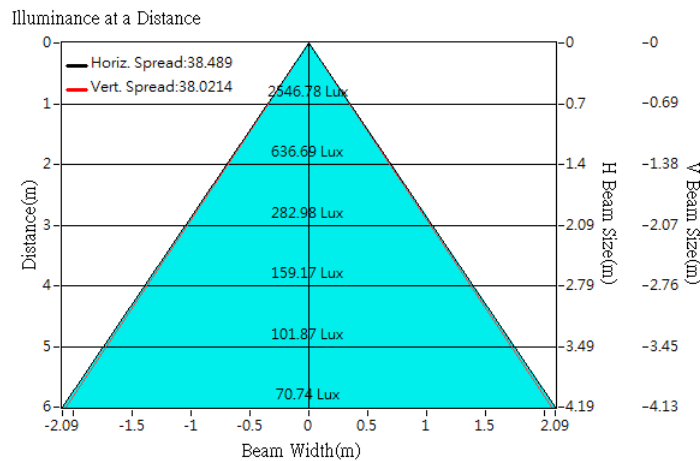



## Optical Characteristics

Model Number	CKO-CH15-060027-4307		<p>"H" definition</p>
LED	<b>CXM-9-AC40</b>		
LES / LED Size	Φ 9.8 mm		
FWHM (D50)	40°		
Field Angle (D10)	72°		
H (distance)	3.65mm		
Dimension	Φ =60 mm, Thickness=26.85 mm		
Luminous Flux	1324 lm	Measured @ 12.3 W	
Material	PC / UL94V2		

## cd/klm

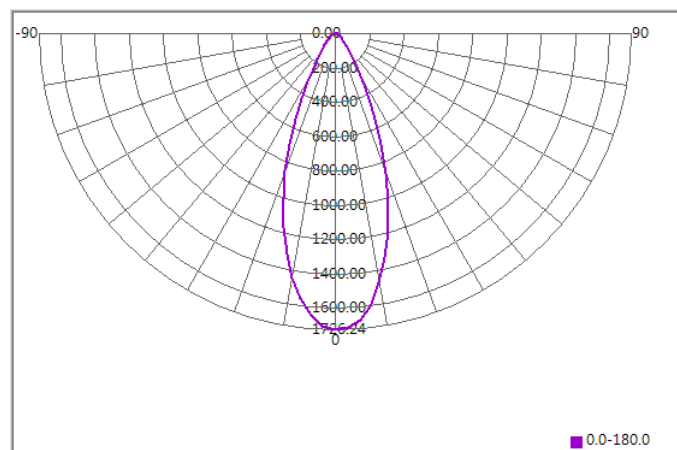

## Illuminance At Distances

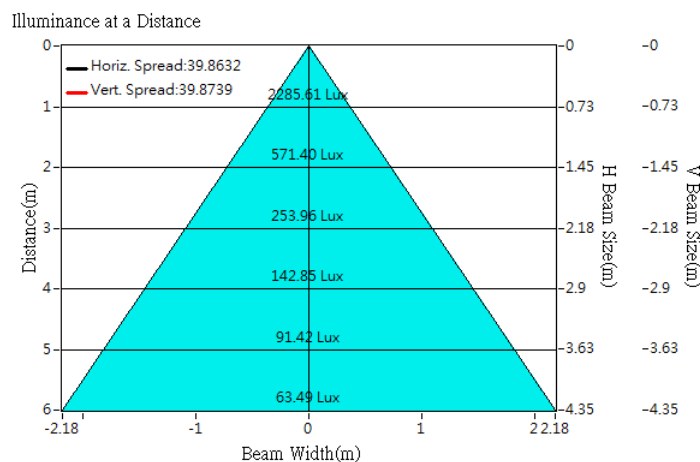



## Optical Characteristics

Model Number	CKO-CH15-060027-4307		<p>"H" definition</p> <p>LES CoB</p>
LED	<b>CXM-11-AC30</b>		
LES / LED Size	Φ 11.7 mm		
FWHM (D50)	41°		
Field Angle (D10)	73°		
H (distance)	3.65mm		
Dimension	Φ =60 mm, Thickness=26.85 mm		
Luminous Flux	1630 lm	Measured @ 15.7 W	
Material	PC / UL94V2		

## cd/klm

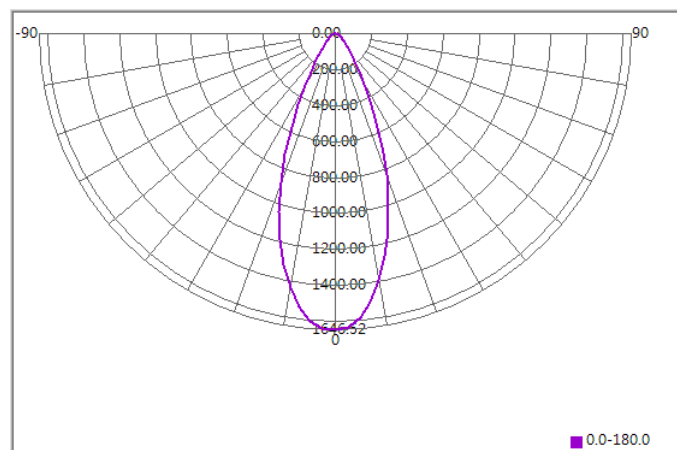

## Illuminance At Distances

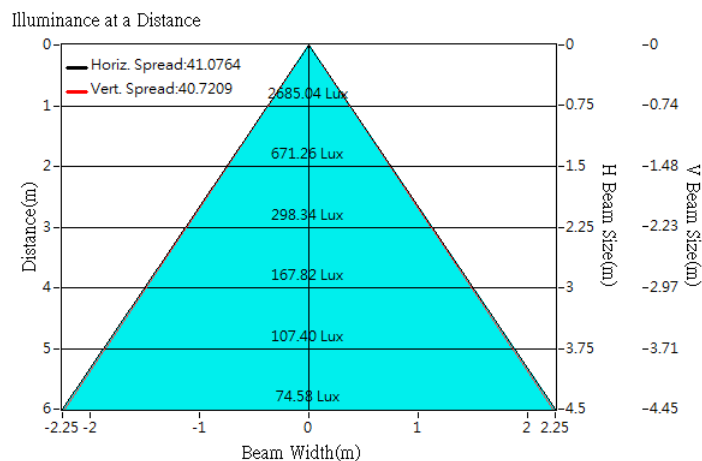



## Optical Characteristics

Model Number	CKO-CH15-060027-4307		<p>"H" definition</p> <p>LES CoB</p>
LED	<b>CLM-14-AC40</b>		
LES / LED Size	Φ14.5		
FWHM (D50)	44°		
Field Angle (D10)	79°		
H (distance)	3.65mm		
Dimension	Φ =60 mm, Thickness=26.85 mm		
Luminous Flux	2472 lm	Measured @ 16.6 W	
Material	PC / UL94V2		

## cd/klm

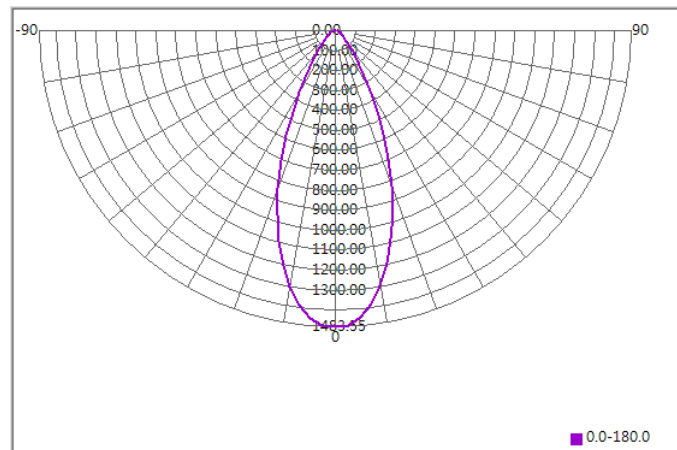

## Illuminance At Distances

