



## Product Model Number

CKO-CH17-092050-0701

### ✓ Model Number Definitions

**CKO-XXXX-XXXXXX-XXXX**



- A. Chun Kuang Optics Corp. Product
- B. Product Type: product abbreviation  
Ex:  
CH→CoB High Intensity  
CC→CoB Compact  
CS→Soft Shading for CoB LED  
HC→Holder for CoB LED

- C. Identity Code
- D. Lens / Fixture Size  
Ex: 075026=Φ75mm / Thickness=26mm (round up)
- E. Serial Numbers

The lens datasheet is applicable for **TRIDONIC LED**, that manufactured by Chun Kuang Optics Corp.

### ✓ Dimensions (mm) : Φ 92 x 49.6

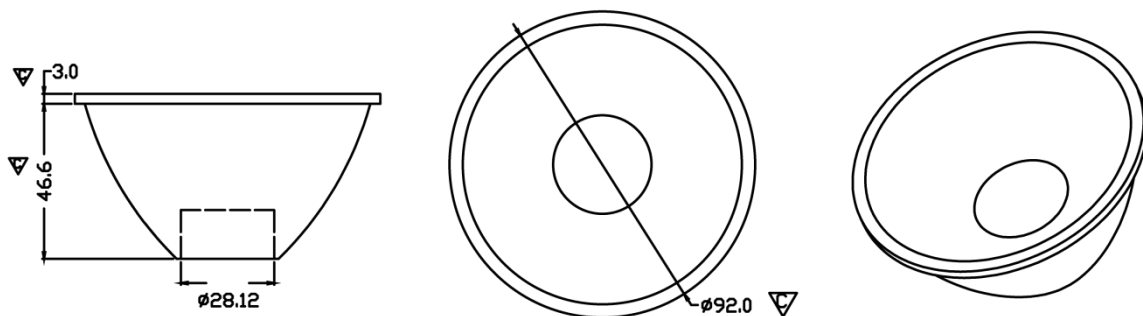

▽:Critical Dimension





## Optical Characteristics

Model Number	CKO-CH17-092050-0701		<p>"H" definition</p> <p>LES</p> <p>CoB</p> <p>"H" mm (distance)</p>
LED	SLE G7 13mm 3000lm 930 R ADV		
LES / LED Size	Φ 13 mm		
FWHM (D50)	14°		
Field Angle (D10)	29°		
H (distance)	3.65 mm		
Dimension	Φ =85 mm, Thickness=46.9 mm		
Luminous Flux	3992 lm	Measured @ 33.1 W	
Material	PC / UL94V2		

## cd/klm

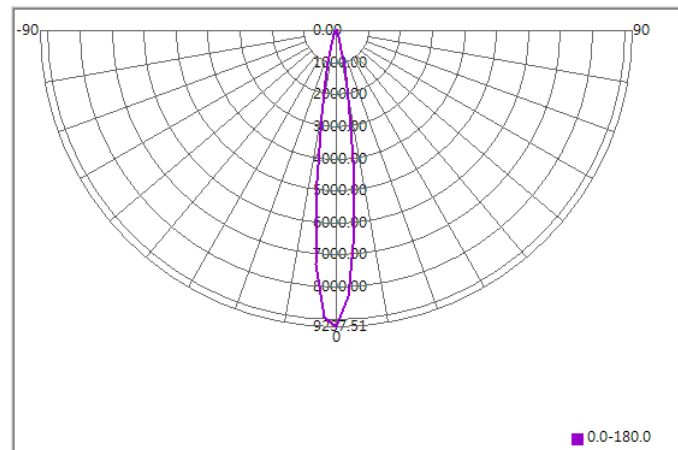

## Illuminance At Distances

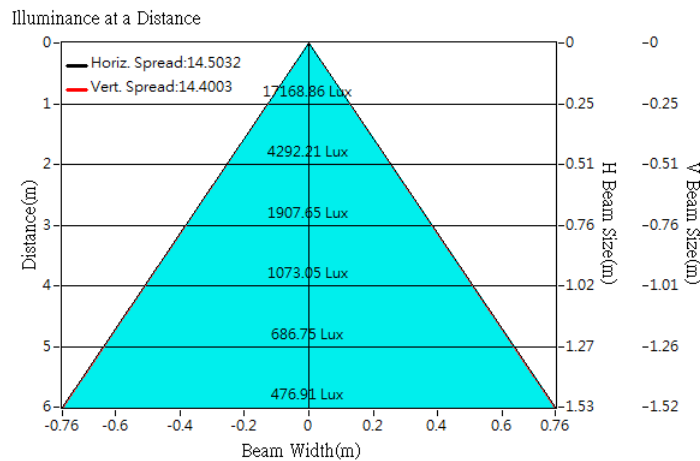



## Optical Characteristics

Model Number	CKO-CH17-092050-0701		<p>"H" definition</p>
LED	SLE G7 15mm 4000lm 840 R ADV		
LES / LED Size	Φ 15 mm		
FWHM (D50)	15°		
Field Angle (D10)	31°		
H (distance)	3.65 mm		
Dimension	Φ =85 mm, Thickness=46.9 mm		
Luminous Flux	3992 lm	Measured @ 33.1 W	
Material	PC / UL94V2		

## cd/klm

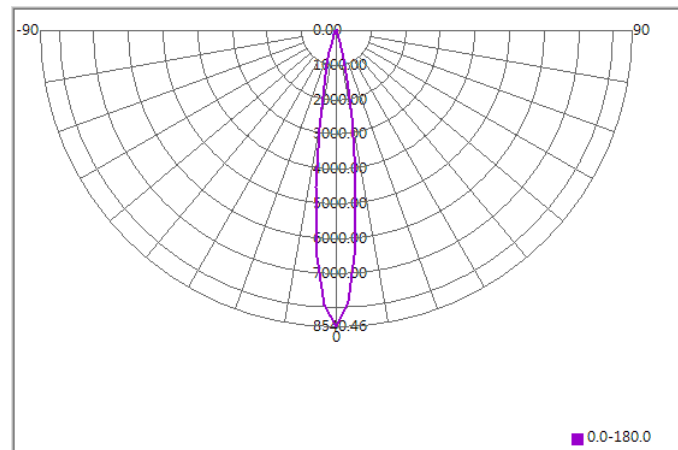

## Illuminance At Distances

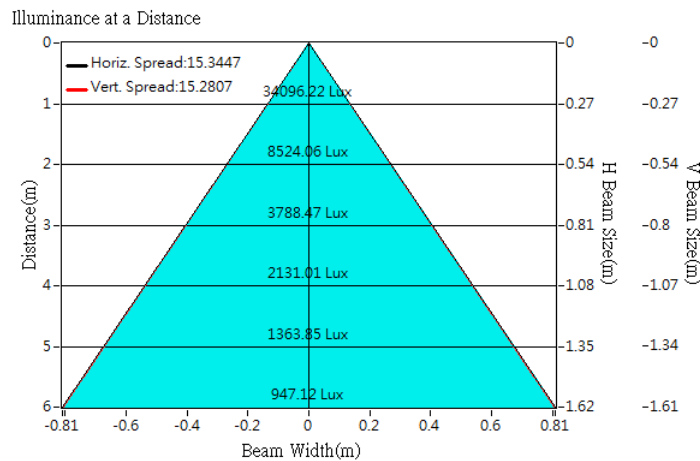



## Optical Characteristics

Model Number	CKO-CH17-092050-0701		
LED	SLE G7 17mm 5000lm 830 R ADV		
LES / LED Size	Φ 17 mm		
FWHM (D50)	17°		
Field Angle (D10)	36°		
H (distance)	3.65 mm		
Dimension	Φ =92 mm, Thickness=49.6 mm		
Luminous Flux	4630 lm	Measured @ 38.3 W	
Material	PC / UL94V2		

## cd/klm

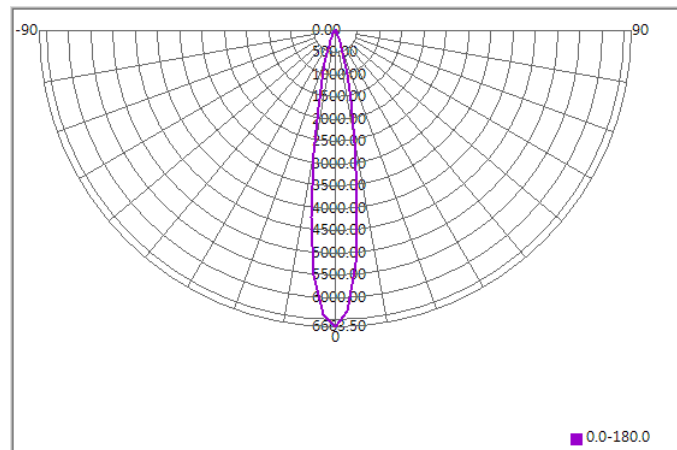

## Illuminance At Distances

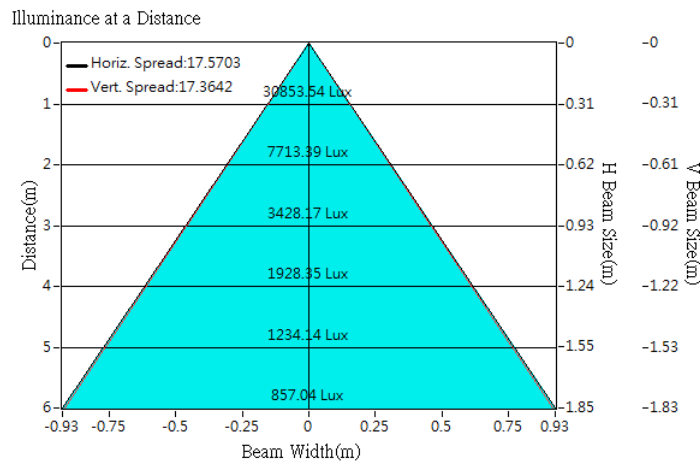



## Optical Characteristics

Model Number	CKO-CH17-092050-0701		<p>"H" definition</p> <p>LES</p> <p>CoB</p>
LED	SLE G7 21mm 6000lm 840 R ADV		
LES / LED Size	Φ 21 mm		
FWHM (D50)	21°		
Field Angle (D10)	45°		
H (distance)	3.65 mm		
Dimension	Φ =92 mm, Thickness=49.6 mm		
Luminous Flux	6280 lm	Measured @ 50.8 W	
Material	PC / UL94V2		

## cd/klm

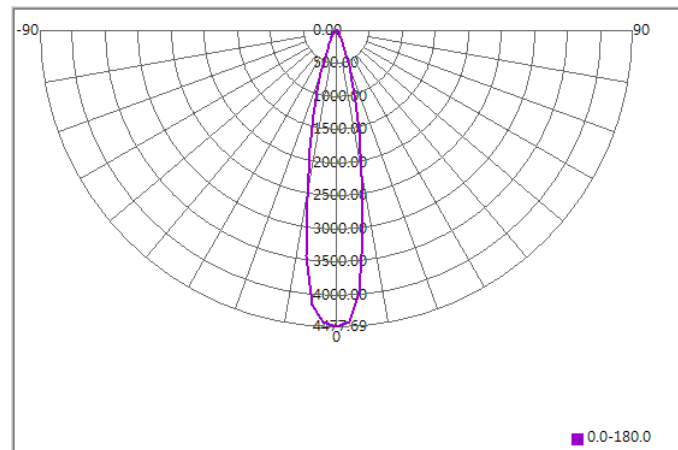

## Illuminance At Distances

