



Product Model Number

CKO-CS15-060027-4204

✓ Model Number Definitions

CKO-XXXX-XXXXXX-XXXX



- A. Chun Kuang Optics Corp. Product
- B. Product Type: product abbreviation
Ex:
CH→CoB High Intensity
CC→CoB Compact
CS→Soft Shading for CoB LED
HC→Holder for CoB LED

- C. Identity Code
- D. Lens / Fixture Size
Ex: 075026=Φ75mm / Thickness=26mm (round up)
- E. Serial Numbers

The lens datasheet is applicable for **Luminus LED**, that manufactured by Chun Kuang Optics Corp.

✓ Dimensions (mm) : Φ60 x 26.85

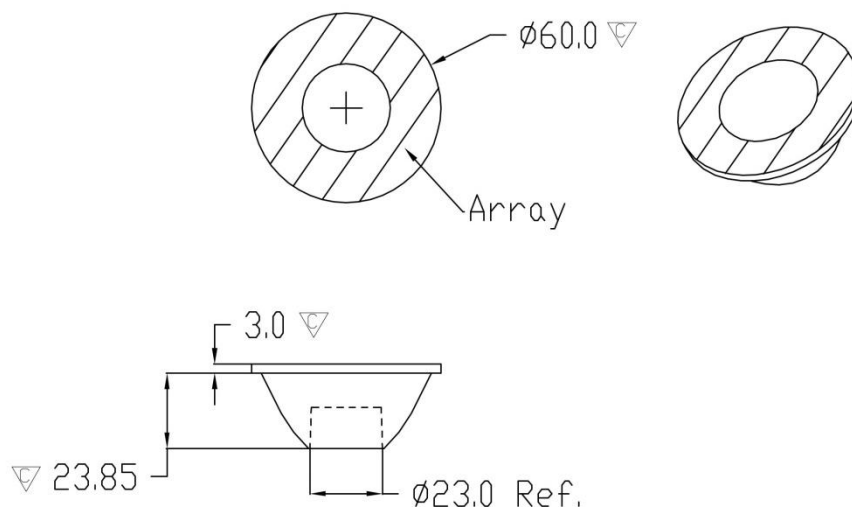

▽:Critical Dimension



✓ **Optical Characteristics – Angle Performances**

Luminus	LED LES (mm)	FWHM (degrees)	Field Angle (degrees)
CXM-9-AC30	Φ9.6	23°	47°
CXM-9-AC40	Φ9.8	23°	47°
CXM-11-AC30	Φ11.7	24°	49°
CLM-14-AC40	Φ14.5	27°	55°



Optical Characteristics

Model Number	CKO-CS15-060027-4204	<p>"H" definition</p> <p>LES CoB</p>
LED	CXM-9-AC30	
LES / LED Size	Φ 9.6 mm	
FWHM (D50)	23°	
Field Angle (D10)	47°	
H (distance)	3.65 mm	
Dimension	Φ =60 mm, Thickness=26.85 mm	
Luminous Flux	1316 lm Measured @ 12.1 W	
Material	PC / UL94V2	

cd/klm

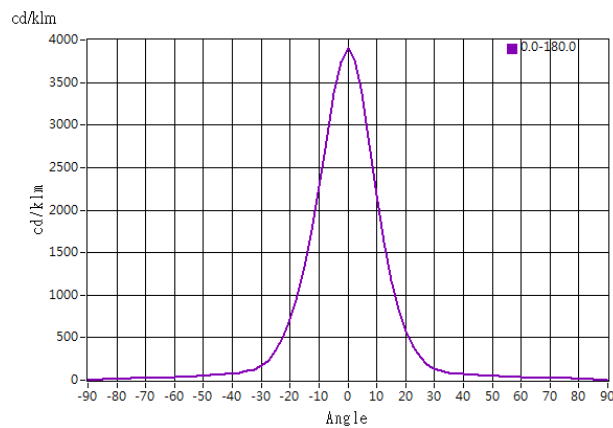

Illuminance At Distances

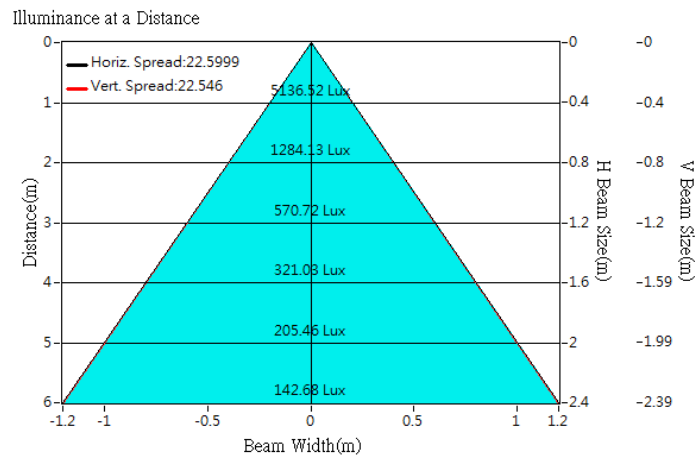



Optical Characteristics

Model Number	CKO-CS15-060027-4204		<p>"H" definition</p>
LED	CXM-9-AC40		
LES / LED Size	Φ 9.8 mm		
FWHM (D50)	23°		
Field Angle (D10)	47°		
H (distance)	3.65 mm		
Dimension	Φ =60 mm, Thickness=26.85 mm		
Luminous Flux	1299 lm	Measured @ 12.3 W	
Material	PC / UL94V2		

cd/klm

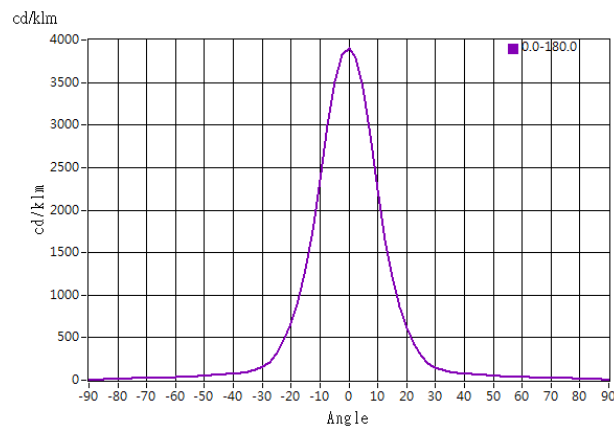

Illuminance At Distances

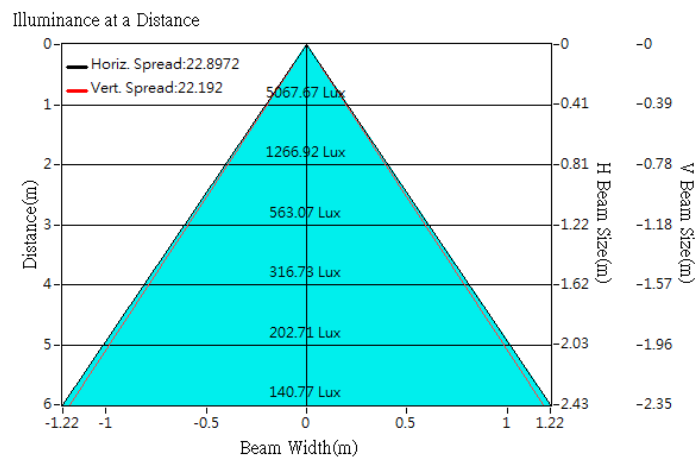



Optical Characteristics

Model Number	CKO-CS15-060027-4204	<p>"H" definition</p> <p>LES CoB</p>
LED	CXM-11-AC30	
LES / LED Size	Φ 11.7 mm	
FWHM (D50)	24°	
Field Angle (D10)	49°	
H (distance)	3.65 mm	
Dimension	Φ =60 mm, Thickness=26.85 mm	
Luminous Flux	1584 lm	
Material	PC / UL94V2	

cd/klm

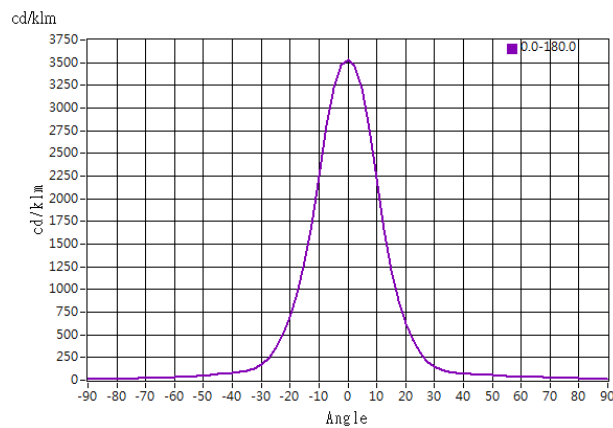

Illuminance At Distances

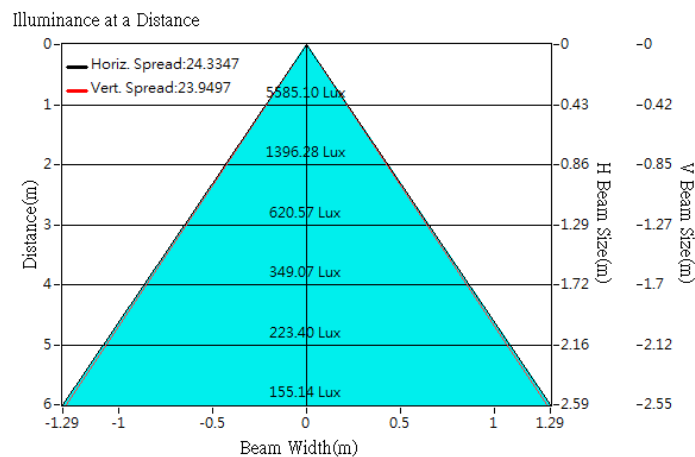



Optical Characteristics

Model Number	CKO-CS15-060027-4204		<p>"H" definition</p>
LED	CLM-14-AC40		
LES / LED Size	Φ 14.5 mm		
FWHM (D50)	24°		
Field Angle (D10)	45°		
H (distance)	3.65 mm		
Dimension	Φ =60 mm, Thickness=26.85 mm		
Luminous Flux	2325 lm	Measured @ 16.7 W	
Material	PC / UL94V2		

cd/klm

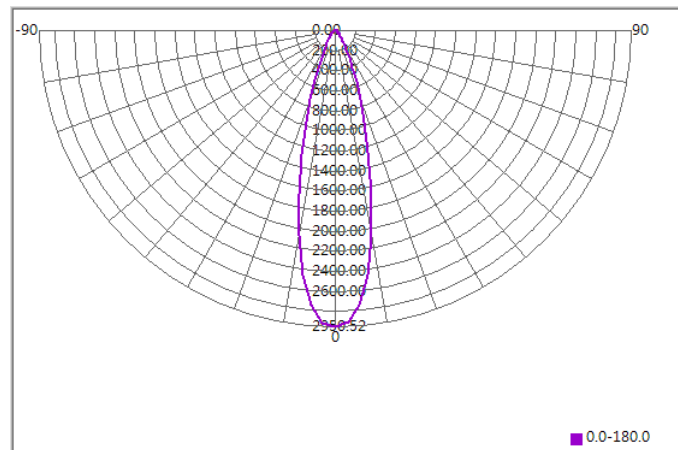

Illuminance At Distances

