



## Product Model Number

CKO-CS17-045021-1307

### ✓ Model Number Definitions

**CKO-XXXX-XXXXXX-XXXX**

(A)

(B)

(C)

(D)

(E)

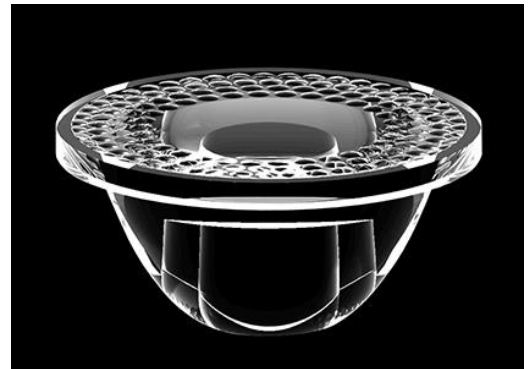

- A. Chun Kuang Optics Corp. Product
- B. Product Type: product abbreviation  
Ex:  
CH→CoB High Intensity  
CC→CoB Compact  
CS→Soft Shading for CoB LED  
HC→Holder for CoB LED

- C. Identity Code
- D. Lens / Fixture Size  
Ex: 075026=Φ75mm / Thickness=26mm (round up)
- E. Serial Numbers

The lens datasheet is applicable for **TRIDONIC LED**, that manufactured by Chun Kuang Optics Corp.

### ✓ Dimensions (mm) : Φ45 x 20.9

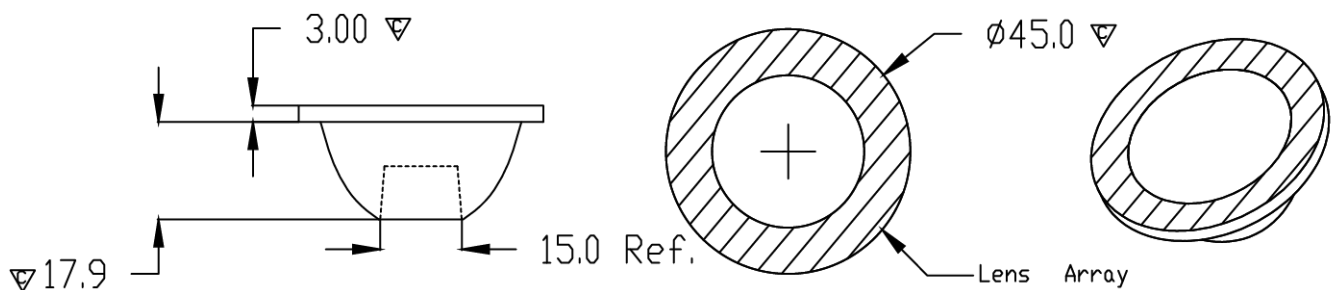

▽:Critical Dimension



### ✓ Optical Characteristics – Angle Performances

TRIDONIC	LED LES (mm)	FWHM (degrees)	Field Angle (degrees)
SLE G7 09mm 1200lm 940 R ADV	Φ9	42°	83°
SLE G7 13mm 3000lm 930 R ADV	Φ13	50°	92°



## Optical Characteristics

Model Number	CKO-CS17-045021-1307		
LED	SLE G7 09mm 1200lm 940 R ADV		
LES / LED Size	Φ 9 mm		
FWHM (D50)	42°		
Field Angle (D10)	83°		
H (distance)	2.5 mm		
Dimension	Φ =45 mm, Thickness=20.9 mm		
Luminous Flux	1417 lm	Measured @ 12.3 W	
Material	PC / UL94V2		

## cd/klm

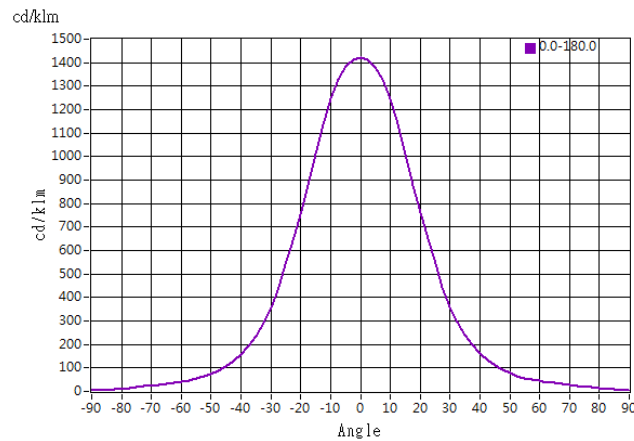

## Illuminance At Distances

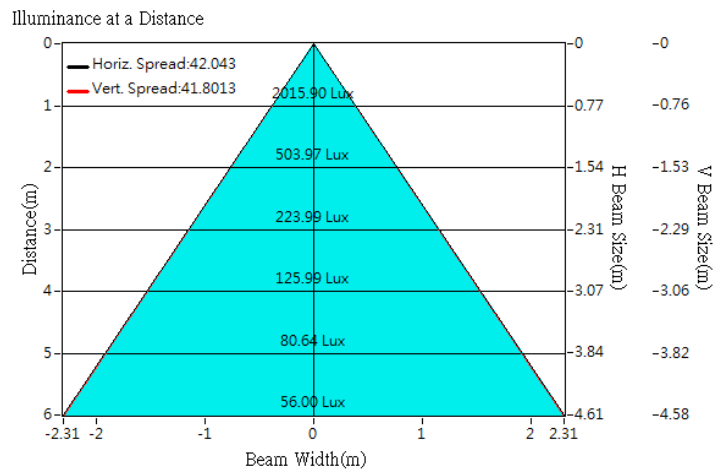



## Optical Characteristics

Model Number	CKO-CS17-045021-1307		<p>"H" definition</p>
LED	SLE G7 13mm 3000lm 930 R ADV		
LES / LED Size	Φ 13 mm		
FWHM (D50)	50°		
Field Angle (D10)	92°		
H (distance)	4 mm		
Dimension	Φ =45 mm, Thickness=20.9 mm		
Luminous Flux	1912 lm	Measured @ 18 W	
Material	PC / UL94V2		

## cd/klm

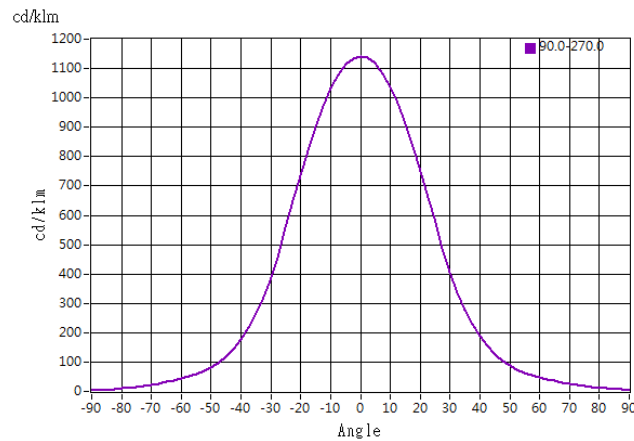

## Illuminance At Distances

